

# China Radial internal Clearance of Spherical Plain Bearings ,bearings,ball bearings Manufacturer, Supplier, Factory, Exporter in china

TianCheng Bearing Factory mainly produces special bearings,special bearing,special ball bearing,special needle bearing,special non-standard bearings.a professional special bearing manufacturer,special bearing factory,our other bearings are pillow block,Rod Ends,ball bearings,non-standard bearings,Ball Joint Rod Ends,Spherical Plain Bearings,,automotive bearings,auto bearing,We always get satisfactory feedback from customers.

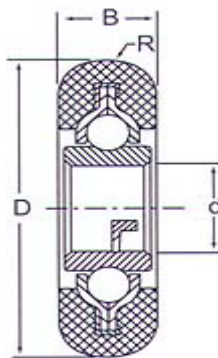

**QSOB**

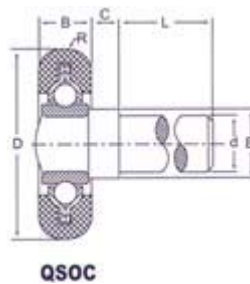

**QSOC**



Bearing No.	Dimension(mm)							Ball	
	D	d	E	B	C	L	R	No.	Dia.
QSOB4601	46	11.2	-	12.5	-	-	6.25	10	1/4
QSOB4701	47.5	11.2	-	12.5	-	-	6.25	10	1/4
QSOB4801	48.5	11.2	-	12.5	-	-	6.25	10	1/4
QSOC4601	46	11.0	15.0	12.5	17.3	85.0	6.25	-	-
QSOC4602	46	11.0	14.0	12.5	14.0	96.0	6.25	-	-
QSOC4603	46	11.0	14.0	12.5	14.0	71.0	6.25	-	-
QSOC4604	46	12.0	14.2	12.5	19.8	86.58	6.25	-	-
QSOC4605	46	12.0	14.2	12.5	19.8	162.5	6.25	-	-
QSOC4606	46	9.4	12.7	12.5	103.7	4.7	6.25	-	-
QSOC4607	46	11.0	15.0	12.5	17.3	165.2	6.25	-	-
QSOC4608	46	12.7	16.0	12.5	13.5	99.0	6.25	-	-
QSOC4609	46	11.0	14.2	12.5	18.8	87.7	6.25	-	-
QSOC4610	46	11.0	14.2	12.5	5.5	76.0	6.25	-	-

QSOC4611	46	11.0	14.2	12.5	12.5	20.75	6.25	-	-
QSOC4612	46	11.0	14.2	12.5	12.5	225.0	6.25	-	-
QSOC4613	46	11.0	14.2	12.5	12.5	94.0	6.25	-	-
QSOC4614	46	11.0	15.0	12.5	17.3	165.2	6.25	-	-
QSOC4615	46	11.0	15.0	12.5	17.3	85.0	6.25	-	-
QSOC4616	46	11.0	14.0	12.5	6.0	82.0	6.25	-	-
QSOC4617	46	11.0	14.2	12.5	12.5	94.0	6.25	-	-

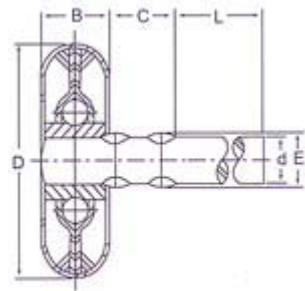

**QSTB**

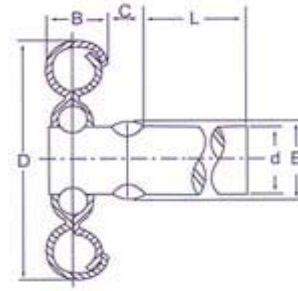

**QSTC**

Bearing No.	Dimension(mm)						Ball	
	D	d	E	B	C	L	No.	Dia.
QSTB4601	46	11.0	13.6	12.0	13.5	88.5	10	1/4
QSTB4602	46	11.0	13.6	12.0	13.5	152.0	10	1/4
QSTB4603	46	11.0	13.6	12.0	13.5	215.1	10	1/4
QSTB4604	46	11.0	13.6	12.0	21.5	80.5	10	1/4
QSTB7701	71	11.0	13.6	18.6	15.8	85.6	11	1/4
QSTB7702	71	11.0	13.6	18.6	15.8	168.1	11	1/4
QSTB7703	71	11.0	13.6	18.6	15.8	212.5	11	1/4
QSTC4601	46	11.0	13.6	11.4	14.1	88.5	7	1/4
QSTC4602	46	11.0	13.6	11.4	15.3	167.3	7	1/4

## Other products

Deep groove ball bearing, Angular contact ball bearing, Self-aligning ball bearing, Deep groove ball bearing, Angular contact ball bearing, Self-aligning ball bearing, **Bearing Unit**, Pillow Block, Rod Ends, Ball Joint Rod Ends, **Special bearings**, Special bearing, Nylon Window Pulley, Plastic Pulley, Conveyor bearing for Roller, Conveyor Wheel, Pressed Thrust Bearing, Pressed Bearing, Unground Low Carbon Steel Bearing, Steel Plastic Rollers For Doors&Vehicles, **Spherical Plain Bearings**, Radial Spherical Plain, Angular Contact Spherical Plain

Bearings , Spherical Plain Thrust Bearings, Tolerances for spherical Plain Bearings, Radial internal Clearance of Spherical Plain Bearings, **Automotive Bearings**, Hub Wheel Bearing, Clutch Release Bearing, Tensioner Idler Bearing, Cv-joint, Steering Wheel Bearing, Water Pump Bearing, **Roller bearing**, Taper Roller Bearing , Needle Roller Bearing, Thrust Roller Bearing, Spherical Roller Bearing, Cylindrical Roller Bearing, **Needle Bearing**, **Linear Bearing**

## Contact us

**Cixi TianCheng Bearings Co.,Ltd.**

Sales Office Add:No.269 Sishan Road, Cixi, Ningbo, P.R.China. 315300

Tel: 0086-574-63886168 Fax: 0086-574-63886166

E-mail:[ivan@bearings-in-china.com](mailto:ivan@bearings-in-china.com)

Website:<http://www.bearings-in-china.com/>